

Great Copsie Way

CHESWICK VILLAGE

APPROXIMATE FLOOR AREA
148.2 SQM / 1595 SQFT



GROUND FLOOR
834 sq ft (76.9 sq m) approx.



1ST FLOOR
552 sq ft (51.2 sq m) approx.

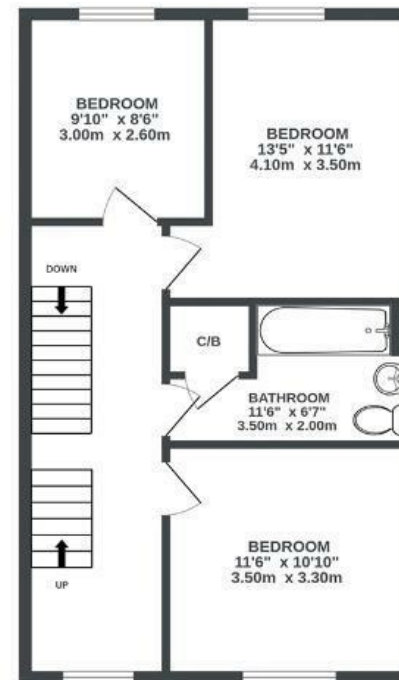

2ND FLOOR
400 sq ft (36.9 sq m) approx.



Illustrations are for reference purposes only, measurements are approximate, not to scale.

Boardwalk

Great Copsie

CHESWICK VILLAGE, BRISTOL

£

£525,000



BS16 1GH

zzz

4 Bedrooms



3 Bathrooms

"For us this home has been great - home working has been easy to manage and the outside space has been lovely for our dog and for enjoying the warm summers and the occasional BBQ. As far as location goes this has been spot on for us - daily walking of Lily in Stoke Park has been super convenient and the Square has Bristol's best Chinese restaurant, a friendly Pizza joint, a bar, and Boston Tea Party too."

